

OPERATION

CAUTION:

Be sure to perform the initialization of the occupant classification ECU if any of the following conditions occur (see page [DI-1829](#)). If the initialization is not performed, the SRS may not operate properly.

- The occupant classification ECU is replaced.
- Accessories (seatback tray, seat cover, etc.) are installed to the vehicle.
- The passenger seat is removed from the vehicle, and then reinstalled or replaced.
- The passenger airbag ON/OFF indicator light ("OFF") comes on when the passenger seat is not occupied.
- The vehicle is brought to the workshop for repair due to an accident or collision.

NOTICE:

The sensitivity check method differs according to the front seat type (separate seat and bench seat, split seat).

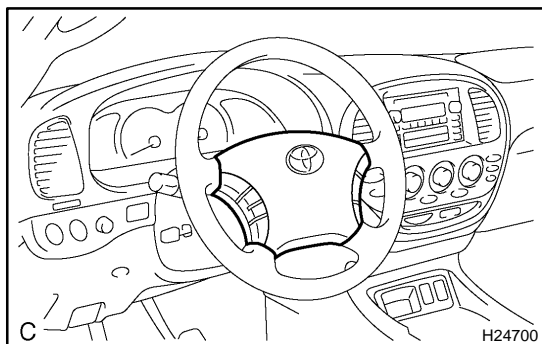

1. STEERING WHEEL PAD

The inflator and bag of the SRS are stored in the steering wheel pad and cannot be disassembled. The inflator contains a squib, igniter charge, and gas generator, etc., and inflates the bag when instructed by the airbag sensor assembly. The steering wheel pad cannot be disassembled.

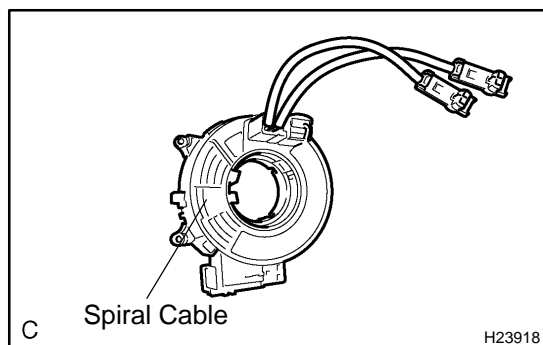

2. SPIRAL CABLE

A spiral cable is used as an electrical joint from the vehicle body side to the steering wheel. The spiral cable cannot be disassembled.

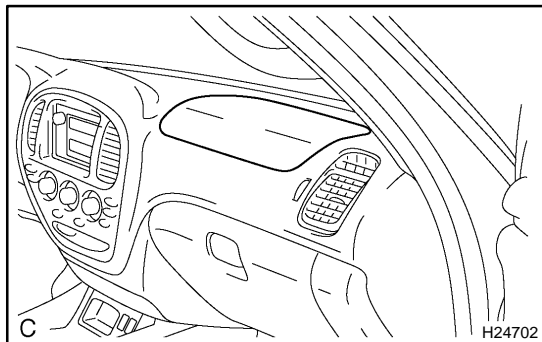

3. FRONT PASSENGER AIRBAG ASSEMBLY

The inflator and bag of the SRS are stored in the front passenger airbag assembly and cannot be disassembled. The inflator contains a squib, igniter charge, gas generator, etc., and inflates the bag when instructed by the airbag sensor assembly. The front passenger airbag assembly cannot be disassembled.

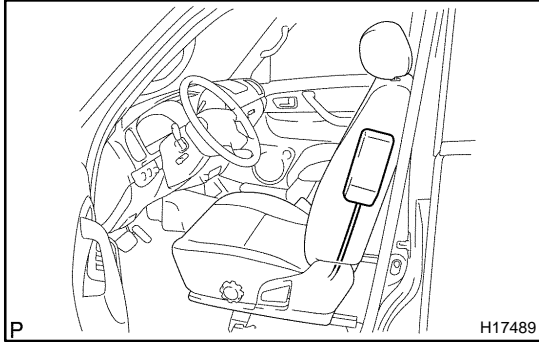

4. SIDE AIRBAG ASSEMBLY

The inflator and bag of the SRS are stored in the side airbag assembly and cannot be disassembled. The inflator contains a squib, igniter charge and gas generator, etc., and inflates the bag when instructed by the airbag sensor assembly. The side airbag assembly cannot be disassembled.

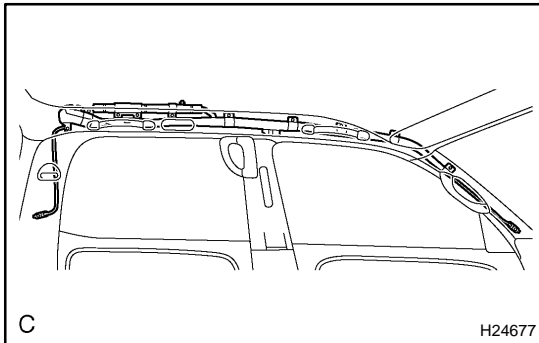

5. CURTAIN SHIELD AIRBAG ASSEMBLY

The inflator and bag of the SRS are stored in the curtain shield airbag assembly and cannot be disassembled. The inflator contains a squib, igniter charge, gas generator, etc., and inflates the bag when instructed by the airbag sensor assembly. The curtain shield airbag assembly cannot be disassembled.

6. SEAT BELT PRETENSIONER

The front seat outer belt has the seat belt pretensioner system. The pretensioner operates in the event of a frontal collision. The seat belt pretensioner cannot be disassembled.

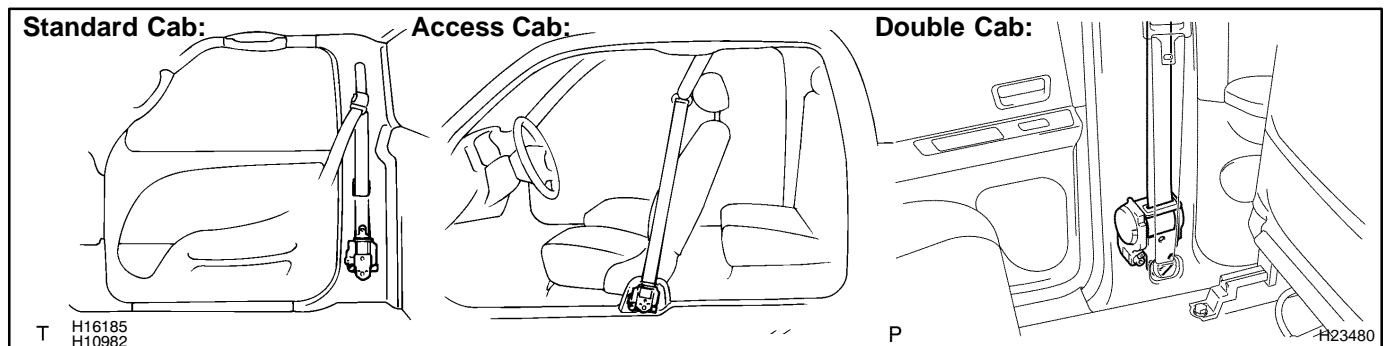

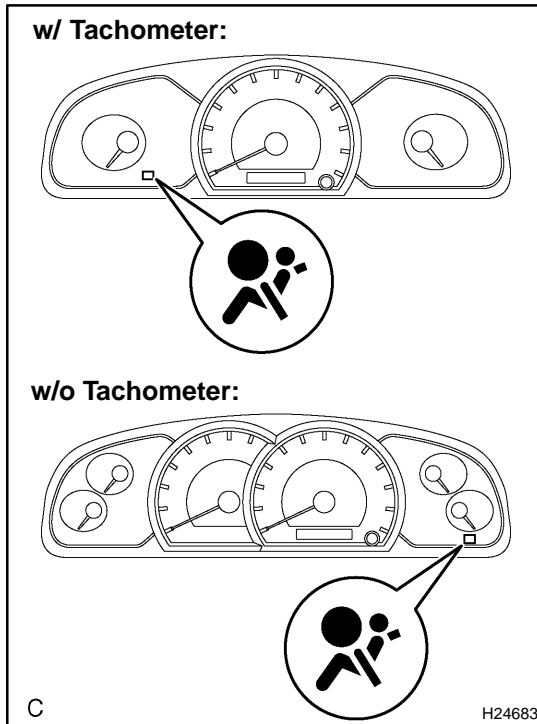

7. SRS WARNING LIGHT

The SRS warning light is located on the combination meter. It comes on to alert the driver of trouble in the system when a malfunction is detected in the airbag sensor assembly. In normal operation conditions when the ignition switch is turned to the ON position, the light comes on for approximately 6 seconds and then goes off.

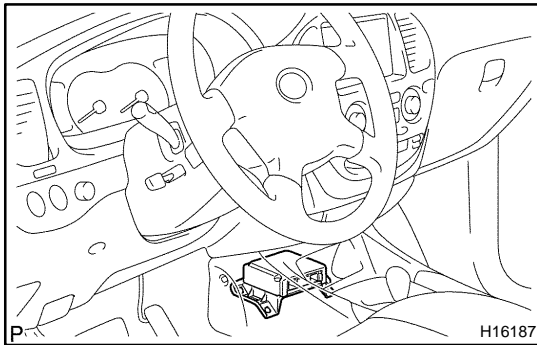

8. AIRBAG SENSOR ASSEMBLY

The airbag sensor assembly is mounted on the floor inside the lower center finish panel. The airbag sensor assembly consists of an airbag sensor, safing sensor, diagnosis circuit, ignition control, drive circuit, etc. It receives signals from the airbag sensor, front airbag sensor, side and curtain shield airbag sensor and curtain shield airbag sensor, and judges whether the SRS must be activated or not. The airbag sensor assembly cannot be disassembled.

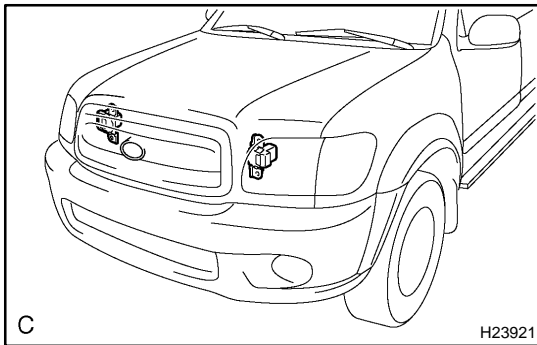

9. FRONT AIRBAG SENSOR

The front airbag sensor is mounted inside each of the radiator support. The front airbag sensor consists of an airbag sensor, diagnosis circuit, etc. It sends signals to the airbag sensor assembly to judge whether the SRS must be activated or not. The front airbag sensor cannot be disassembled.

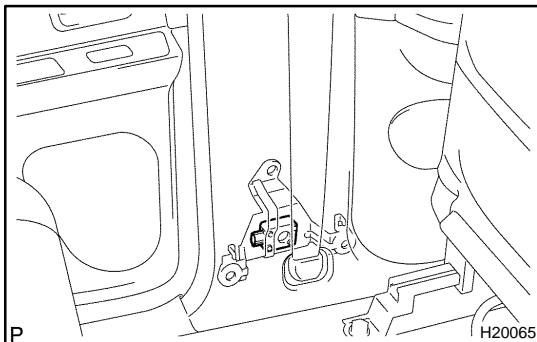

10. SIDE AIRBAG SENSOR ASSEMBLY

The side airbag sensor assembly is mounted in the LH and RH center pillars. The side airbag sensor assembly consists of an airbag sensor, diagnosis circuit, etc. It sends signals to the airbag sensor assembly to judge whether the SRS must be activated or not. The side airbag sensor assembly cannot be disassembled.

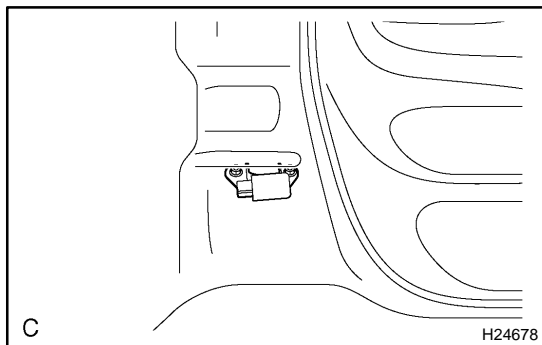
**11. CURTAIN SHIELD AIRBAG SENSOR ASSEMBLY**

The curtain shield airbag sensor assembly is mounted in the LH and RH quarter panels. The curtain shield airbag sensor assembly consists of an airbag sensor, diagnosis circuit, etc. It sends signals to the airbag sensor assembly to judge whether the SRS must be activated or not. The curtain shield airbag sensor assembly cannot be disassembled.

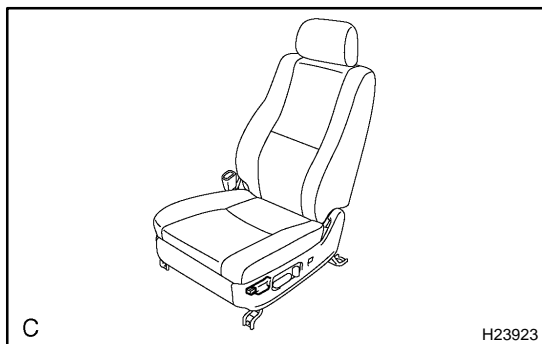
**12. SEAT POSITION SENSOR ASSEMBLY**

The seat position sensor assembly is mounted in the front seat (for driver seat and front passenger seat). The sensor unit consists of a magnet sensor, etc. It judges the seat sliding position and sends the signal to the airbag sensor assembly. The seat position sensor assembly cannot be disassembled.

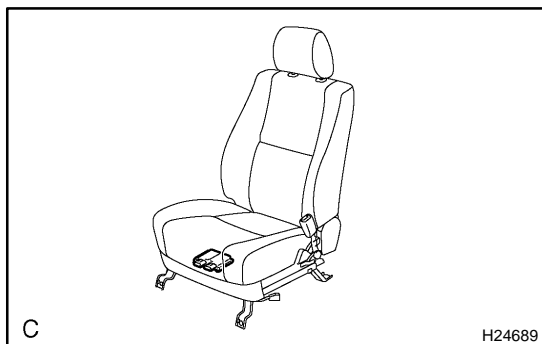
**13. OCCUPANT CLASSIFICATION ECU**

The occupant classification ECU is mounted in the passenger seat. Based on the information sent from the occupant classification ECU, the airbag sensor assembly determines whether the SRS should be activated or not. The occupant classification ECU cannot be disassembled.

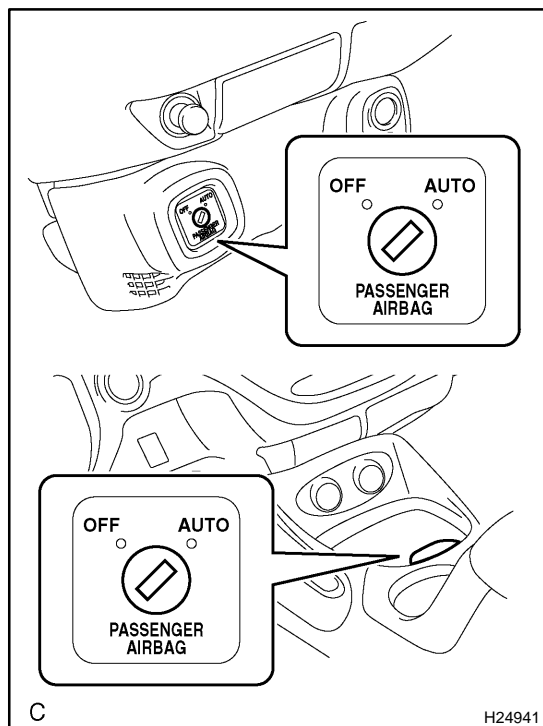

14. PASSENGER AIRBAG MANUAL AUTO-OFF SWITCH

The passenger airbag manual AUTO-OFF switch is mounted on the lower center cover or front console box. By turning the passenger airbag manual AUTO-OFF switch to OFF with the ignition key, the passenger airbag system can be disabled. Also, in order to inform the passenger that the front passenger airbag is disabled, the OFF indicator inside the switch illuminates.

Switch Position	Passenger Airbag	Indicator Light
AUTO	Operative	OFF
OFF	Disabled	ON

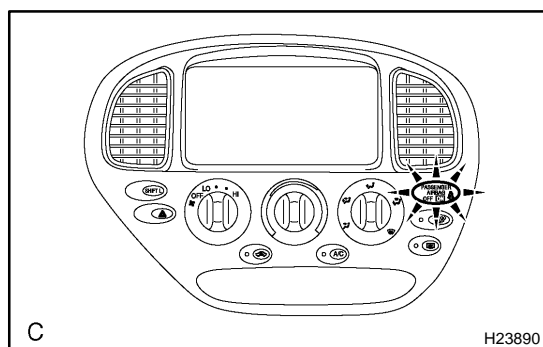

15. RSCA OFF SWITCH

The RSCA OFF switch is located on the switch base. The curtain shield airbag can be switched ON and OFF by pushing the RSCA OFF switch. Also, the RSCA OFF indicator lamp comes on to inform the passenger that the curtain shield airbag is disabled.

Switch Position	Curtain Shield Airbag	Indicator Light
ON	Operative	OFF
OFF	Disabled	ON

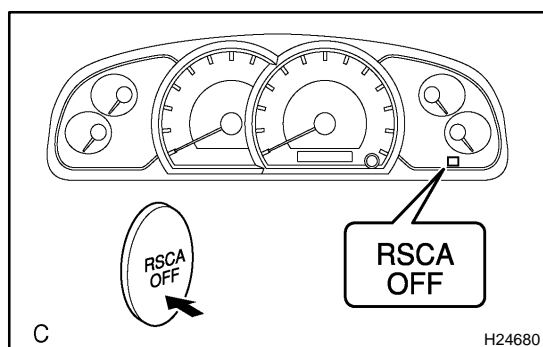

16. SRS CONNECTORS

HINT:

SRS connectors are located as shown in the following illustration.

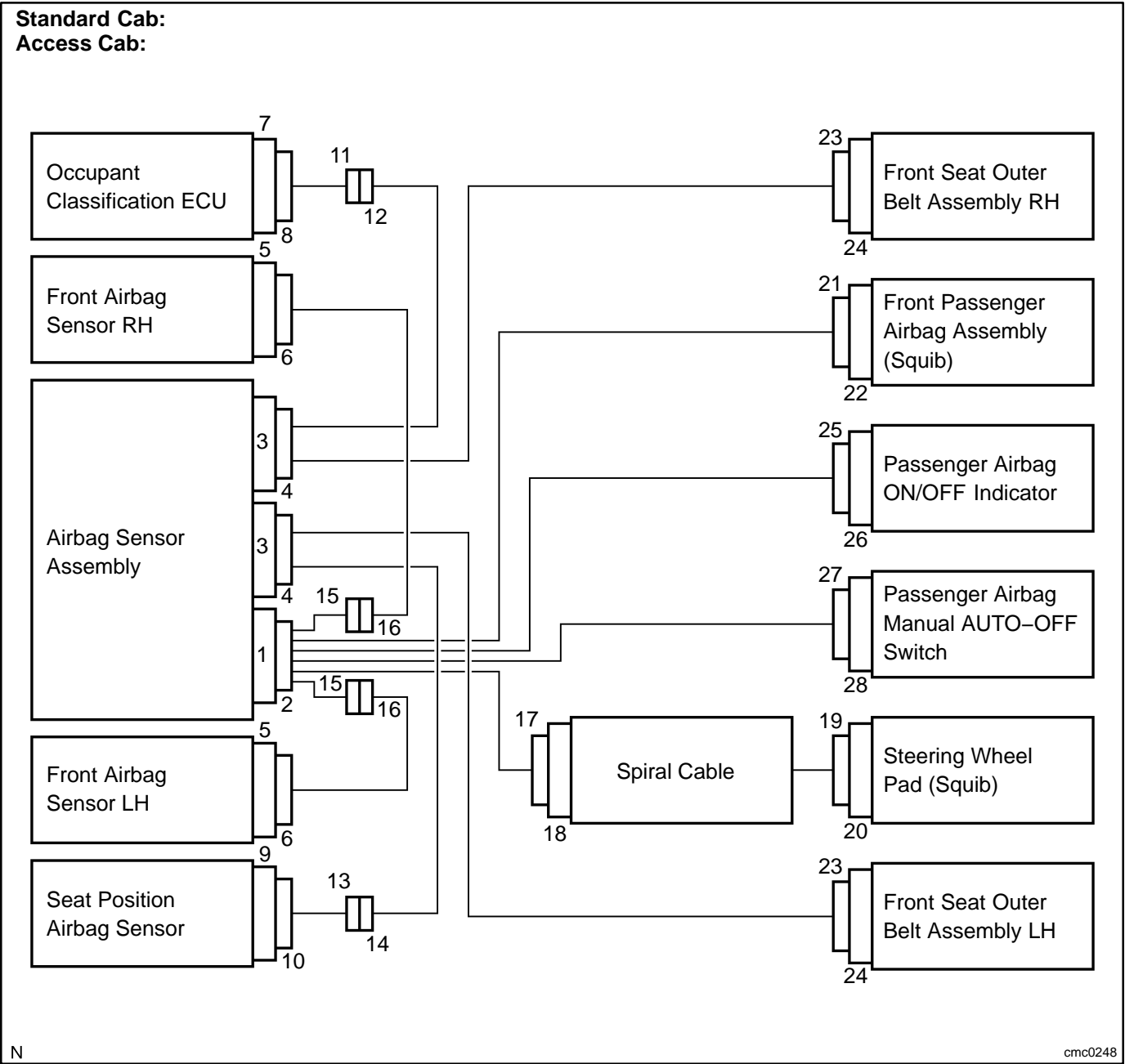

No.	Connector Type	Application
(1)	Terminal Twin-Lock Mechanism	Connectors 2, 4, 16, 17, 21, 22
(2)	Activation Prevention Mechanism	Connectors 2, 4, 18, 20, 22, 24
(3)	Half Connection Prevention Mechanism	Connectors 6, 15, 17, 21
(4)	Connector Lock Mechanism (1)	Connectors 19, 31
(5)	Connector Lock Mechanism (2)	Connectors 2, 4
(6)	Improper Connection Prevention Lock Mechanism	Connectors 1, 3
(7)	RSCA OFF Switch	Connectors 1, 3

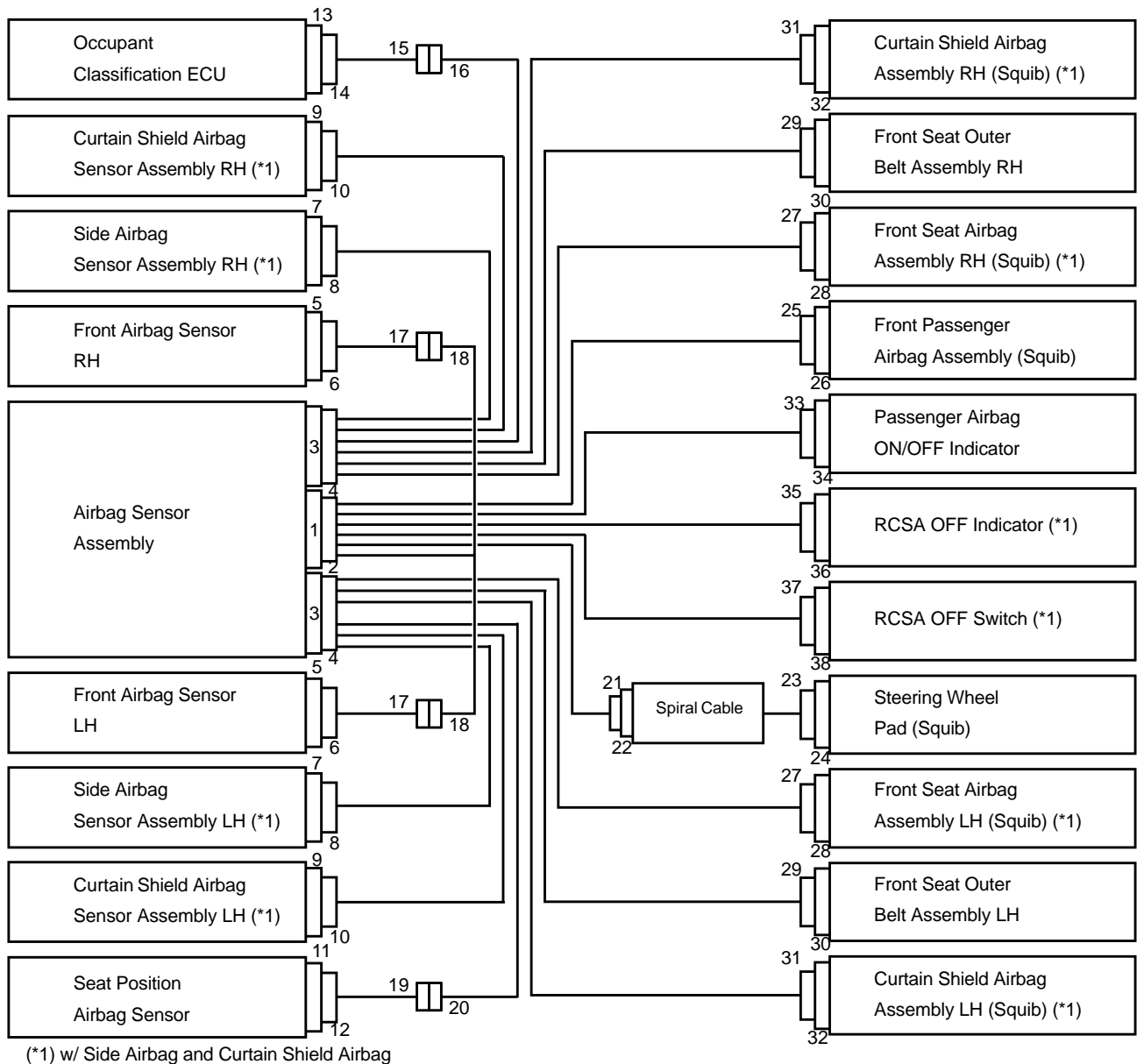
Double Cab:

C

H24699

No.	Connector Type	Application
(1)	Terminal Twin-Lock Mechanism	Connectors 2, 4, 6, 8, 10, 18, 21, 25, 26, 27, 28, 31, 32
(2)	Activation Prevention Mechanism	Connectors 2, 4, 22, 24, 26, 28, 30, 32
(3)	Half Connection Prevention Mechanism	Connectors 6, 8, 10, 17, 21, 25, 27
(4)	Connector Lock Mechanism (1)	Connectors 23, 29
(5)	Connector Lock Mechanism (2)	Connectors 2, 4
(6)	Improper Connection Prevention Lock Mechanism	Connectors 1, 3

- (a) All connectors in the SRS, except the seat position airbag sensor connector and occupant classification ECU connectors, are colored yellow to distinguish them from other connectors. These connectors have special functions, and are specially designed for the SRS. All SRS connectors use durable gold-plated terminals, and are placed in the locations shown on the previous page to ensure high reliability.

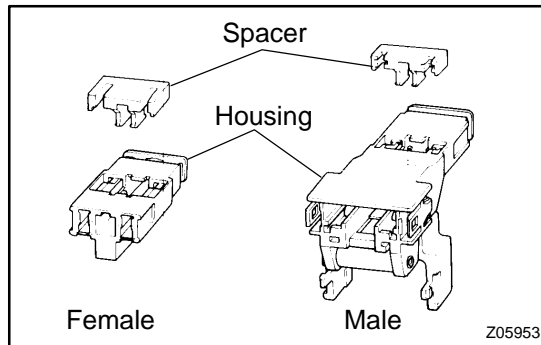

- (1) **Terminal Twin-Lock Mechanism**
Each connector has a two-piece component consisting of a housing and a spacer. This design allows the terminal to be locked securely by two locking devices (the retainer and the lance) to prevent terminals from coming out.
- (2) **Activation Prevention Mechanism**
Each connector contains a short spring plate. When the connector is disconnected, the short spring plate automatically connects the positive (+) terminal and negative (-) terminal of the squib.

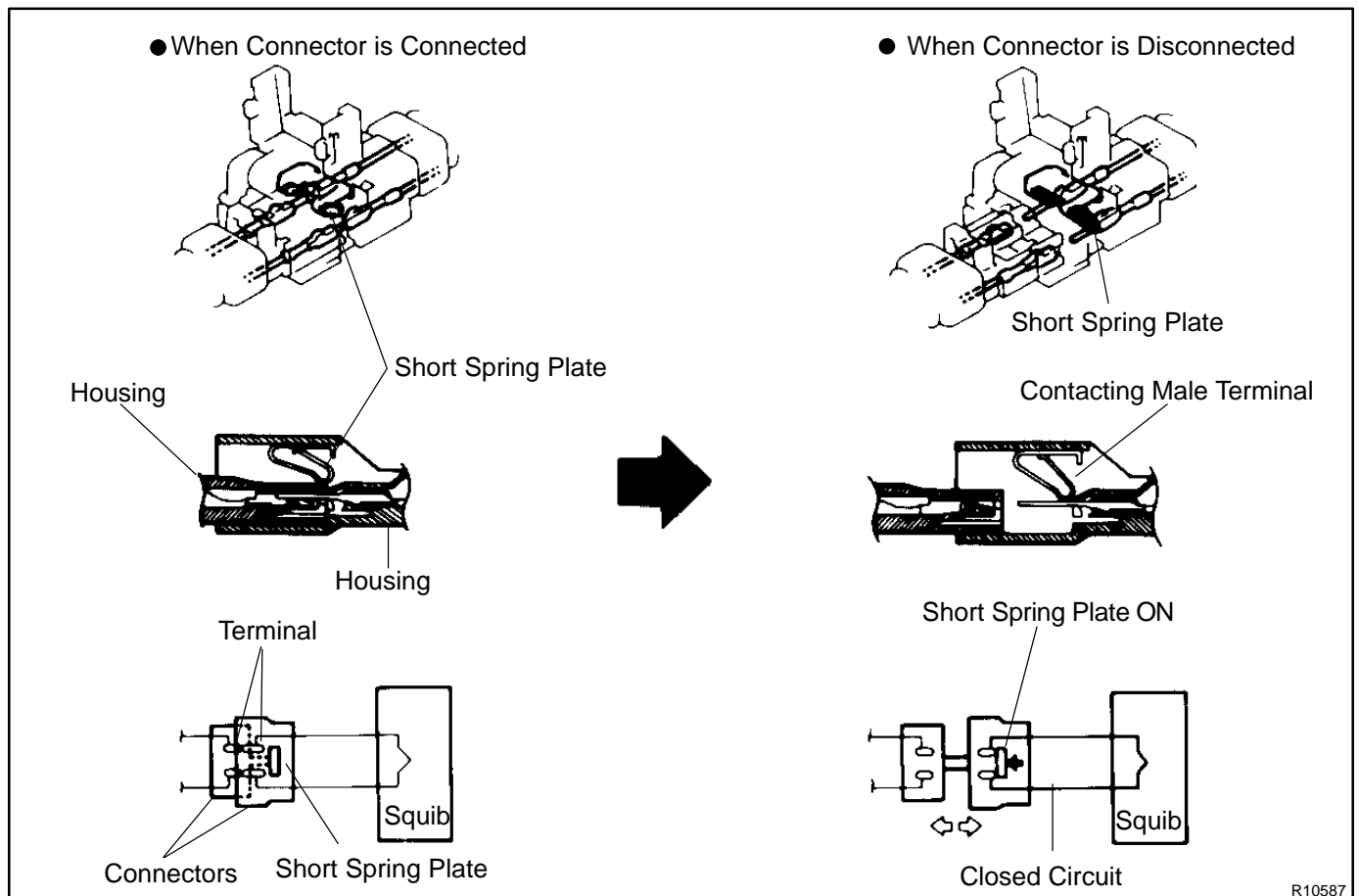

- (3) Half connection prevention mechanism:
If the connector is not completely connected, the connector is disconnected due to the spring operation to the extent that no continuity exists.

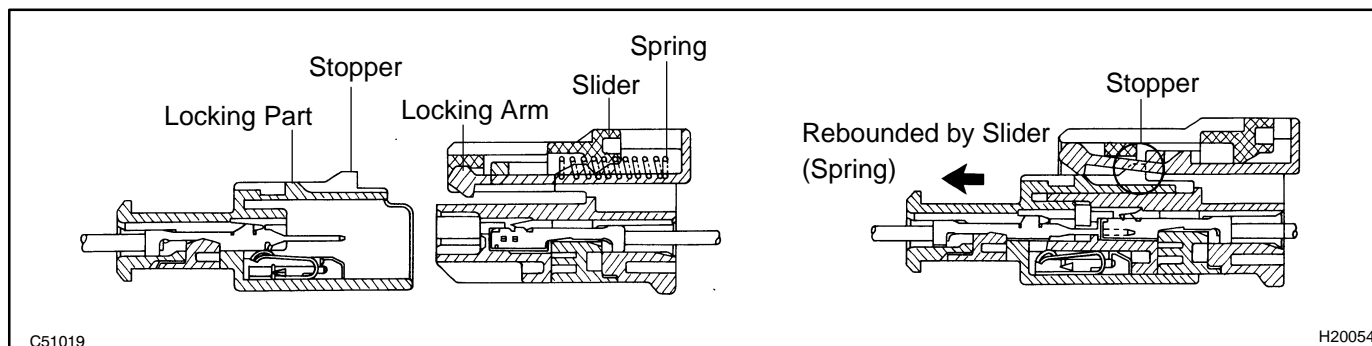

- (4) Connector lock mechanism (1):
Locking the connector lock button securely connects the connector.

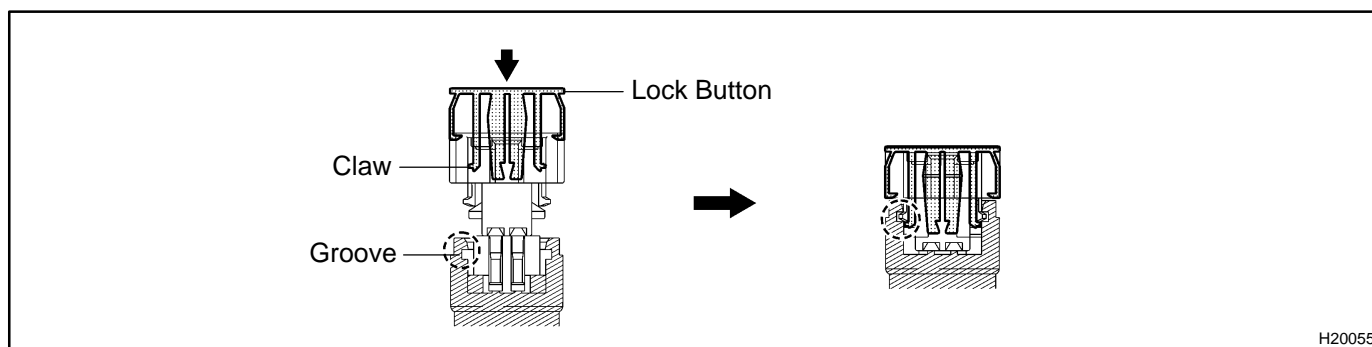

- (5) Connector lock mechanism (2):
Both the primary lock with holder lances and the secondary lock with retainer prevent the connectors from becoming disconnected.

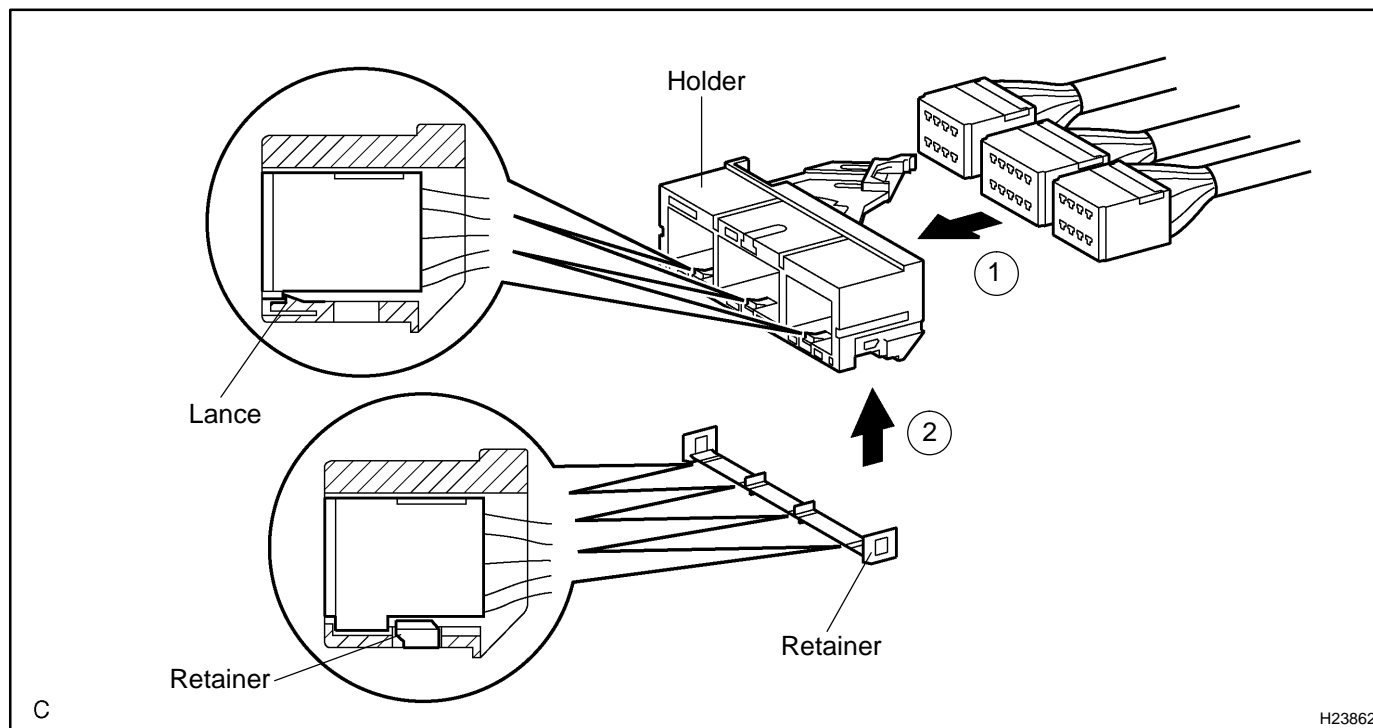

- (6) Improper connection prevention lock mechanism:
When connecting the holder, the lever is pushed into the end by rotating around the A axis to lock the holder securely.

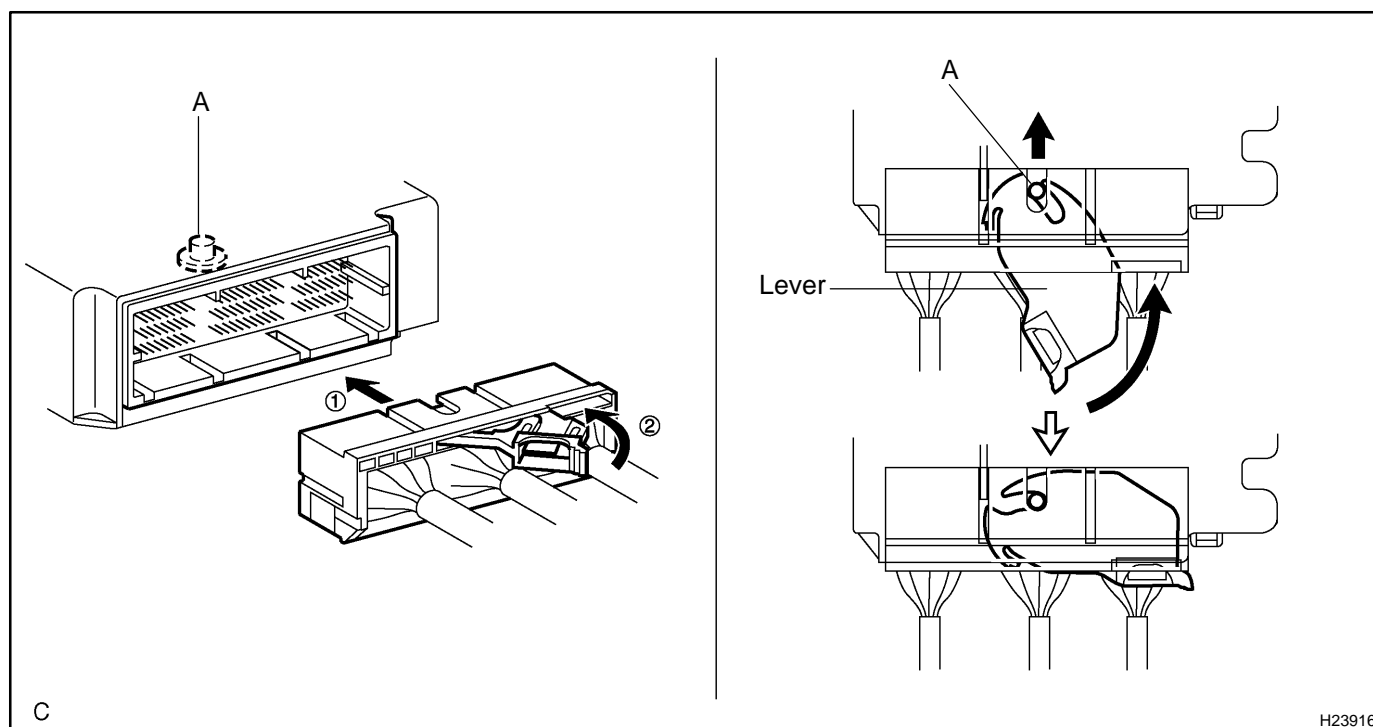

17. DISCONNECTION OF CONNECTORS FOR STEERING WHEEL PAD

- (a) Release the lock button (yellow part) of the connector using a screwdriver.
- (b) Insert the screwdriver tip between the connector and the base, and then raise the connector.

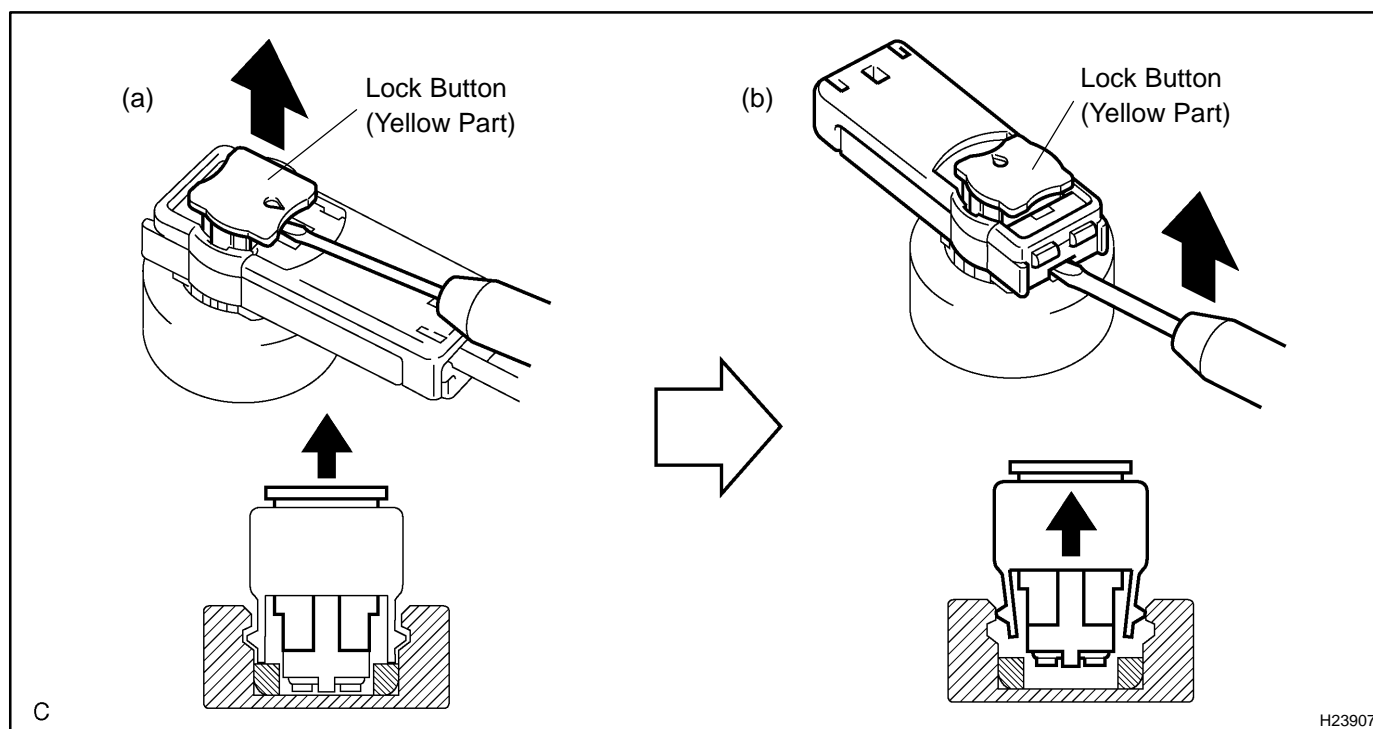
**18. CONNECTION OF CONNECTORS FOR STEERING WHEEL PAD**

- (a) Connect the connector.
- (b) Push down securely on the lock button (yellow part) of the connector. (When locking, a click sound can be heard.)

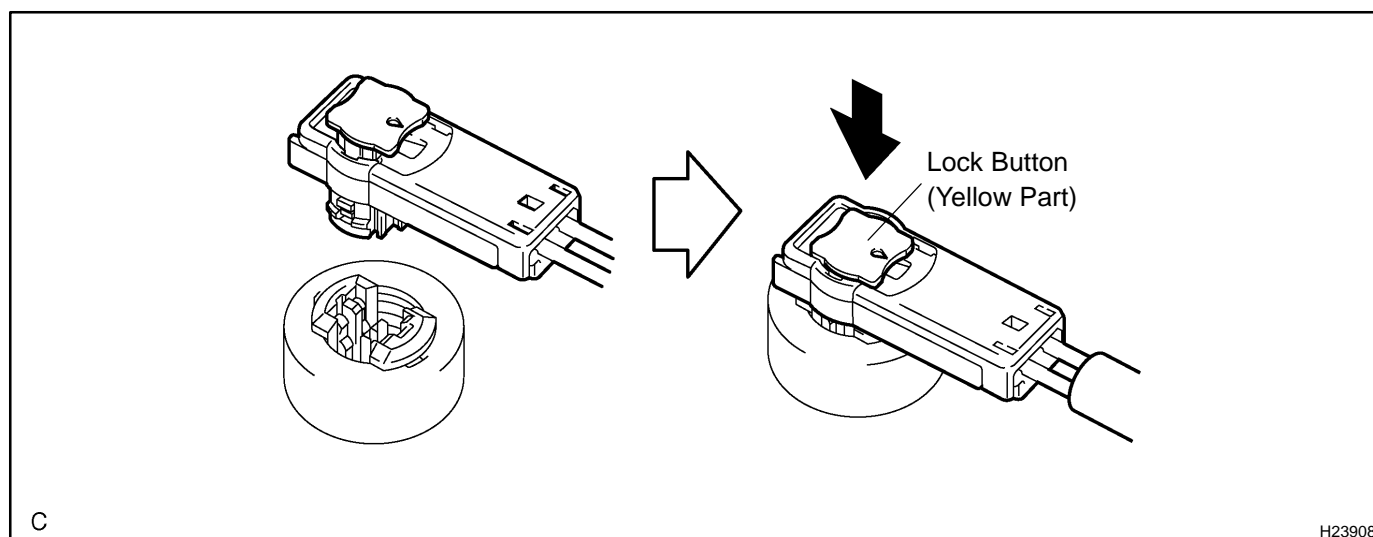

19. DISCONNECTION OF CONNECTORS FOR FRONT PASSENGER AIRBAG ASSEMBLY AND CURTAIN SHIELD AIRBAG ASSEMBLY

- (a) Place a finger on the slider, slide the slider to release the lock, and then disconnect the connector.

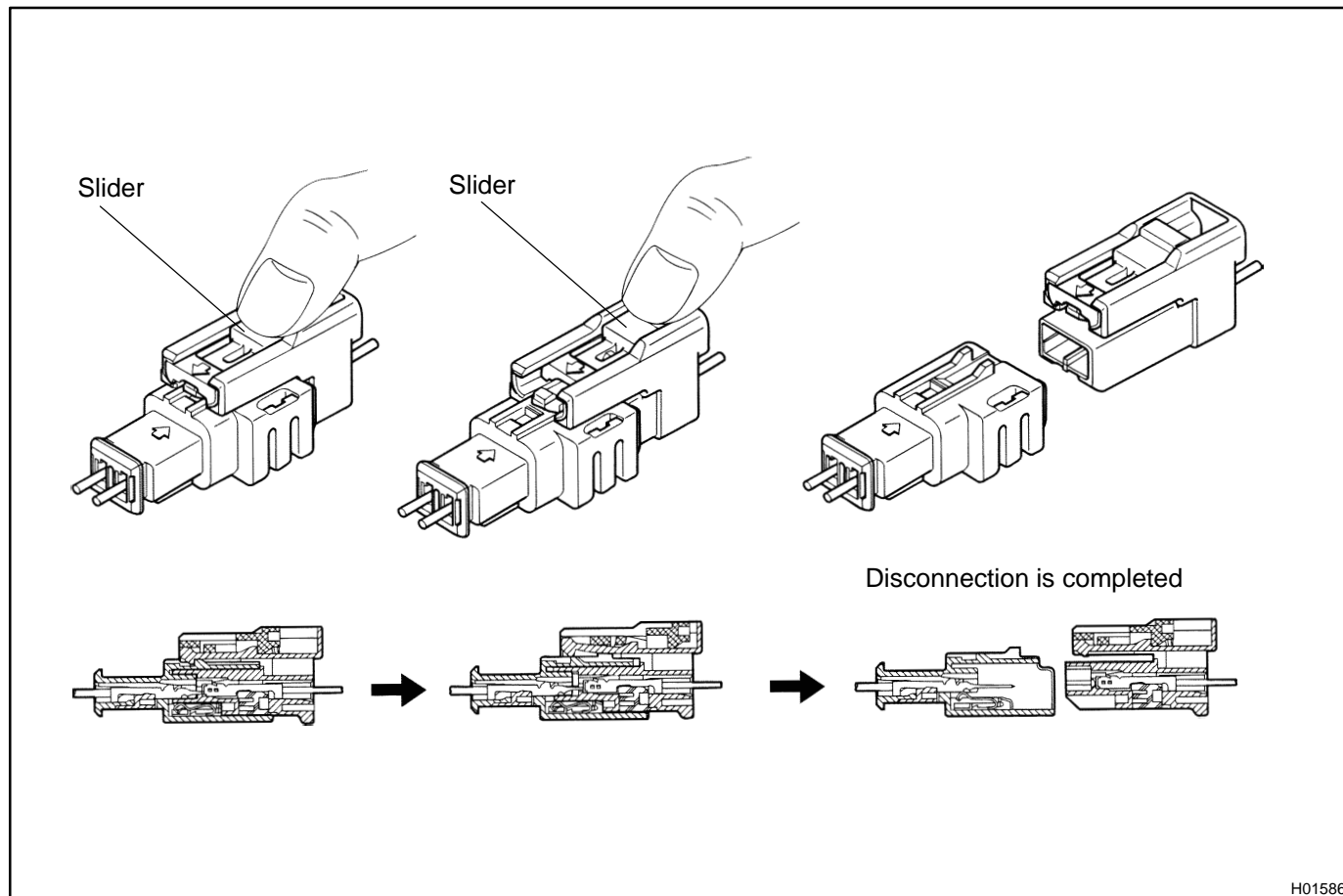
**20. CONNECTION OF CONNECTORS FOR FRONT PASSENGER AIRBAG ASSEMBLY AND CURTAIN SHIELD AIRBAG ASSEMBLY**

- (a) Connect the connector as shown in the illustration. (When locking, make sure that the slider returns to its original position and a click sound can be heard.)

HINT:

When connecting, the slider will slide. Be sure not to touch the slider while connecting, as it may result in an insecure fit.

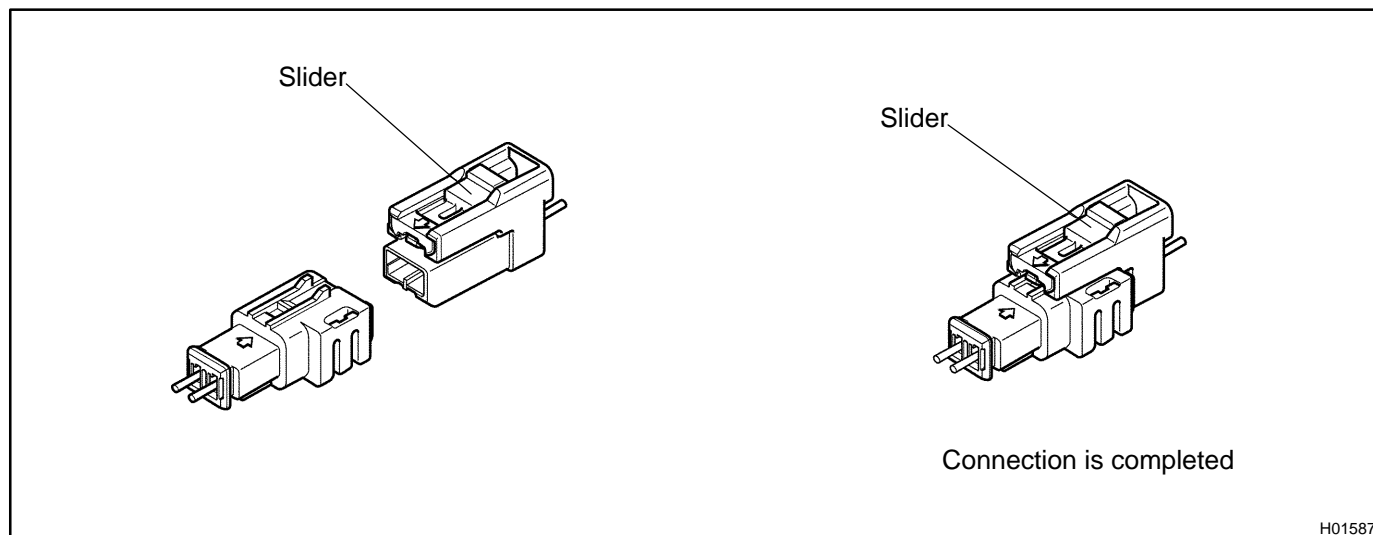

21. DISCONNECTION OF CONNECTOR FOR AIRBAG SENSOR ASSY CENTER

- (a) Pull the lever by pushing part A as shown in the illustration and disconnect the holder (with connectors).

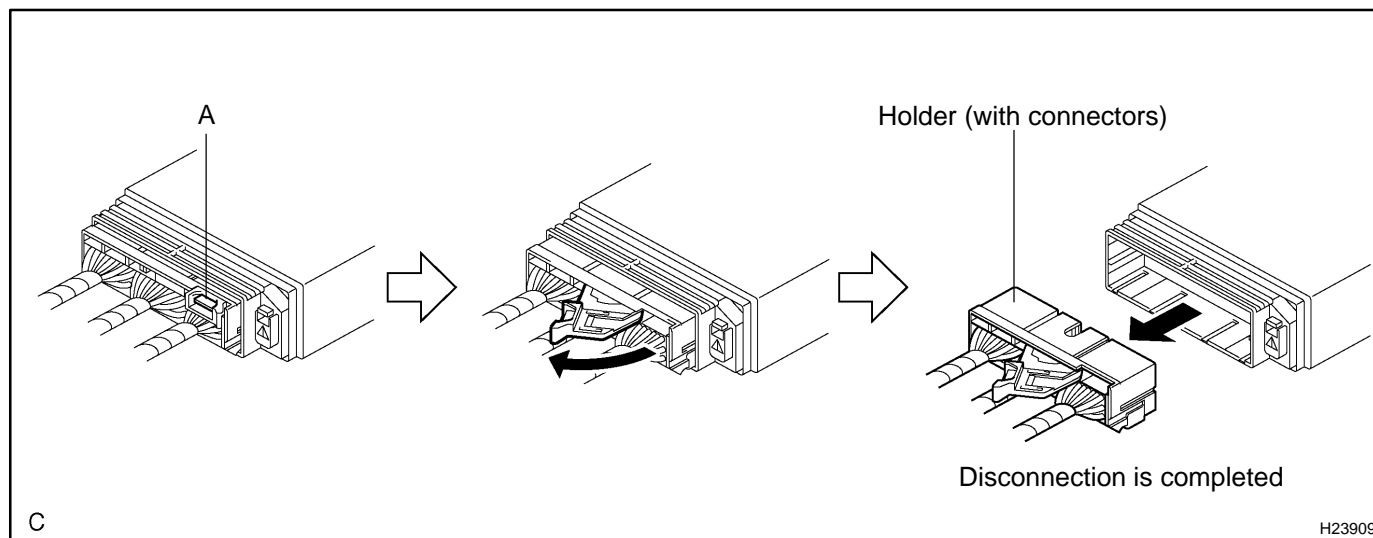
**HINT:**

Perform the following procedures when replacing the holder.

- (b) Remove the holder.
(1) Using a screwdriver, unlock the retainer.

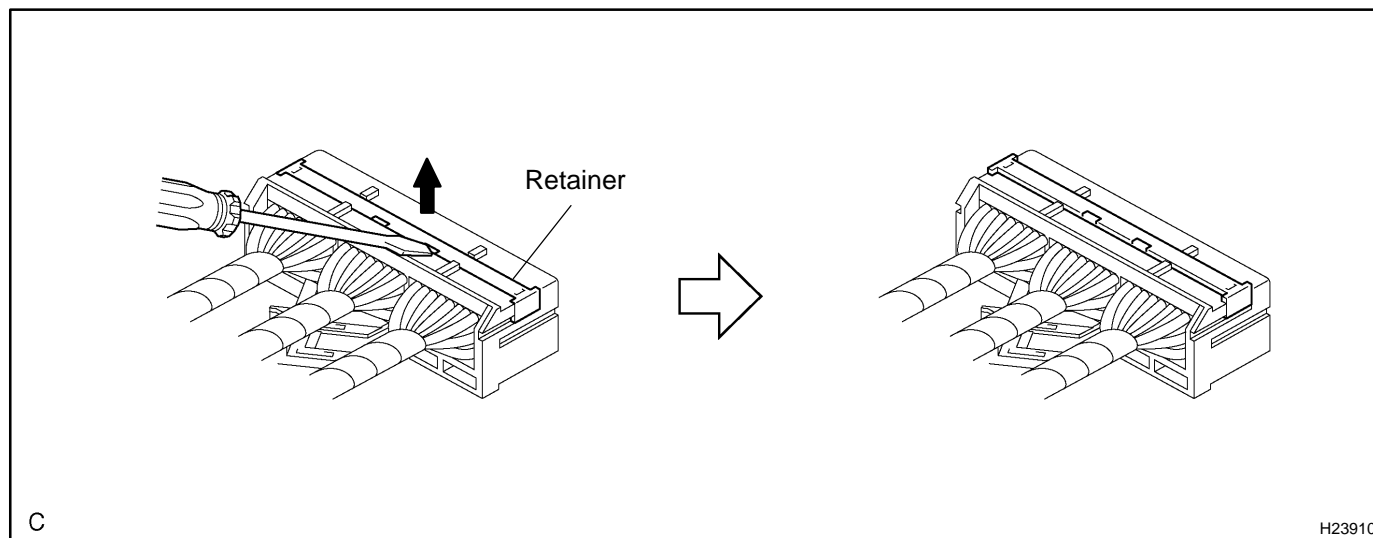

- (2) Release the fitting lances and remove the holder.

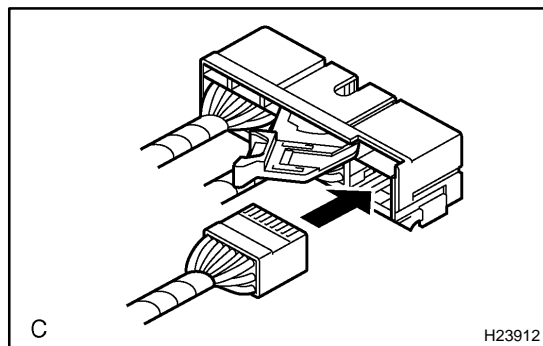
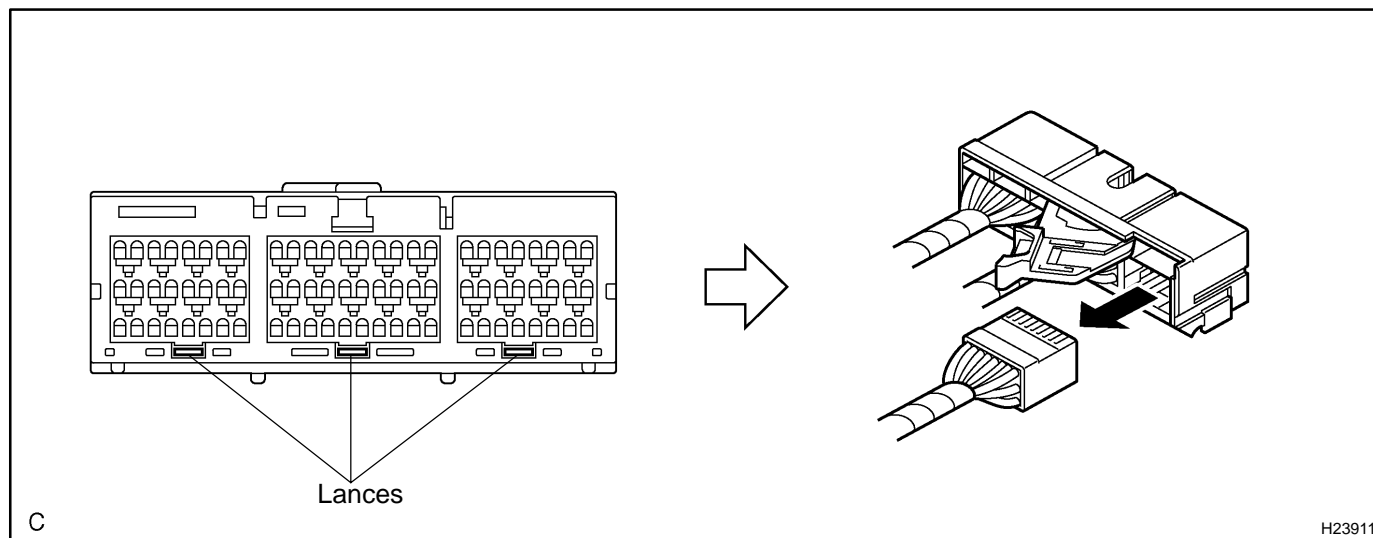

- (c) Install the holder.
(1) Install the connectors to the holder. (When locking, a click sound can be heard.)

HINT:

The retainer is locked when the holder is connected.

22. CONNECTION OF CONNECTOR FOR AIRBAG SENSOR ASSY CENTER

- (a) Firmly insert the holder (with connectors) until it can not be pushed any further.
- (b) Push the lever to connect the holder (with connectors). (When locking, a click sound can be heard.)

HINT:

The holder slides when connecting. Be sure not to hold the holder while connecting, as it may result in an insecure fit.

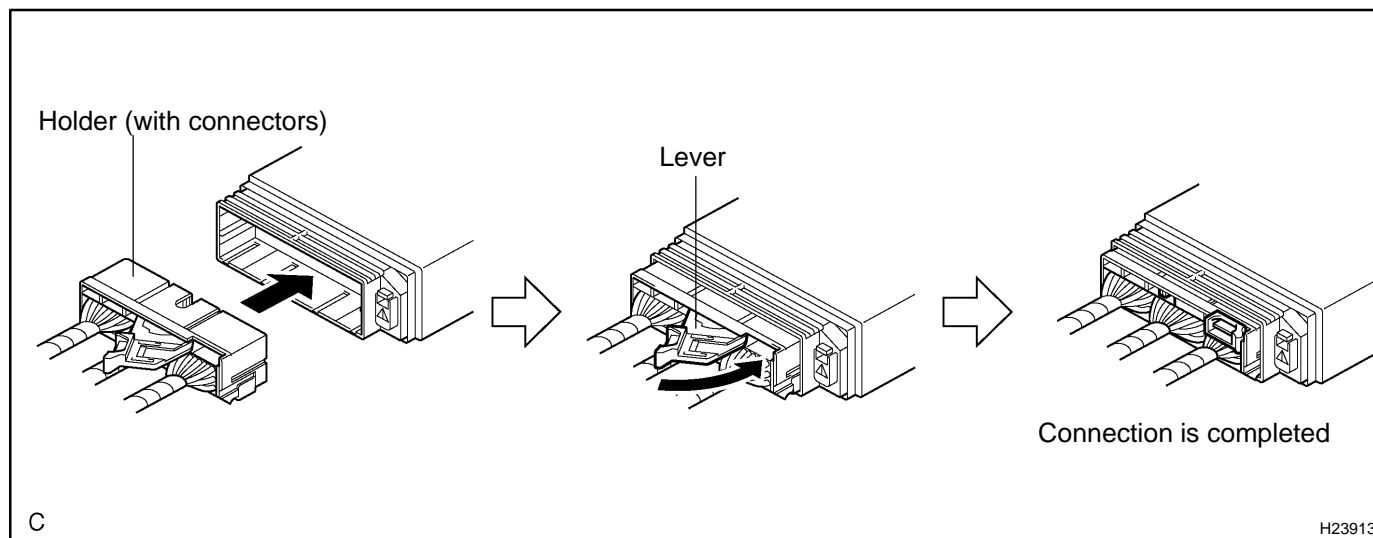

23. DISCONNECTION OF CONNECTOR FOR FRONT AIRBAG SENSOR

- (a) Push down the housing lock (white part) and slide the CPA (yellow part). (At this time, the connector cannot be disconnected yet).
- (b) Push down the housing lock (white part) again and disconnect the connector.

HINT:

Do not push down the A part shown in the illustration when disconnecting.

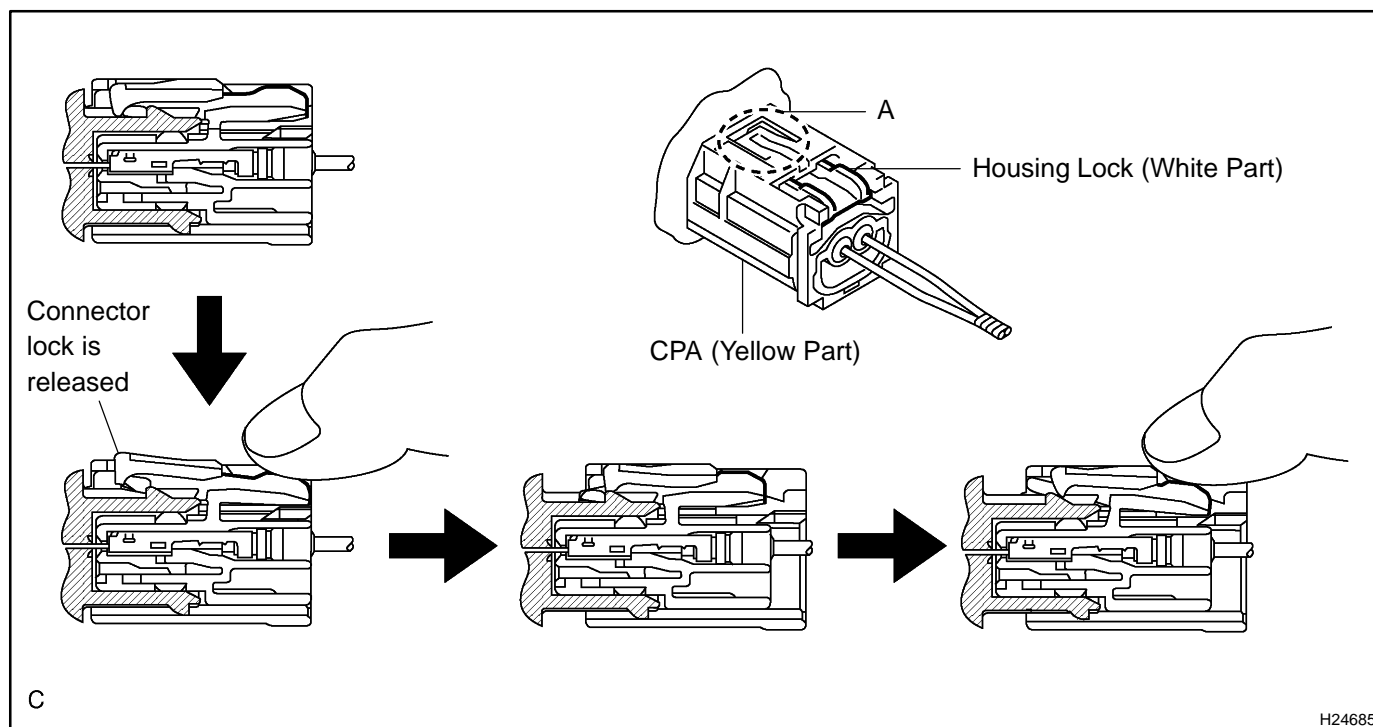

- (c) After disconnecting the connector, check that the position of the housing lock (white part) is as shown in the illustration.

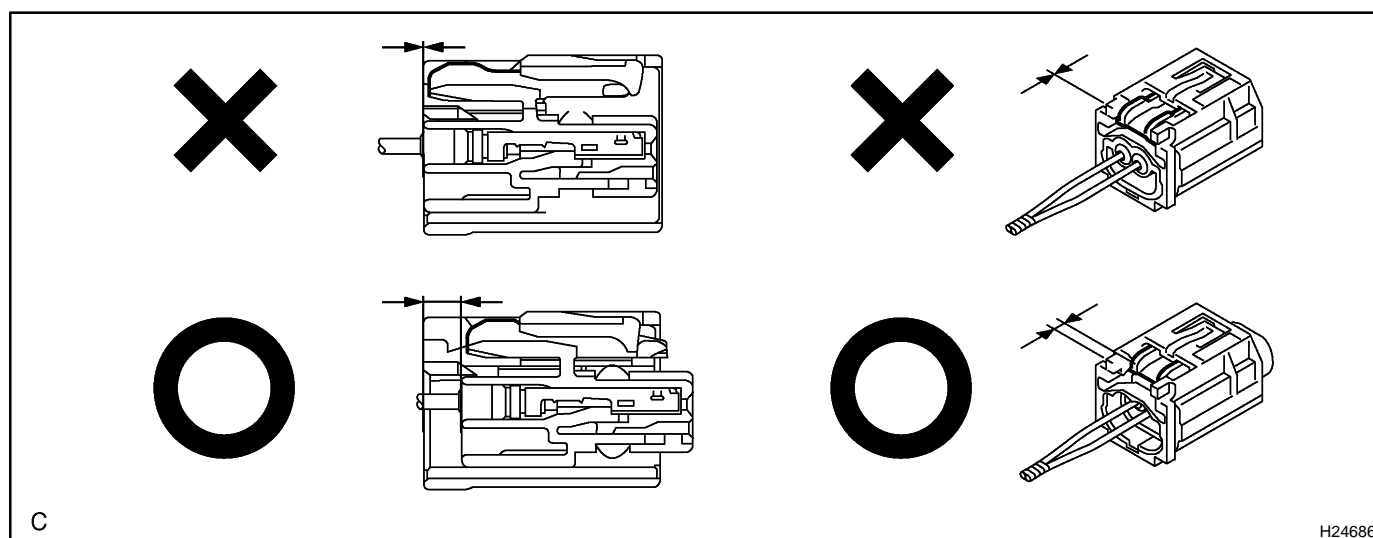

24. CONNECTION OF CONNECTOR FOR FRONT AIRBAG SENSOR

- (a) Before connecting the connectors, check that the position of the housing lock (white part) is as shown in the illustration.

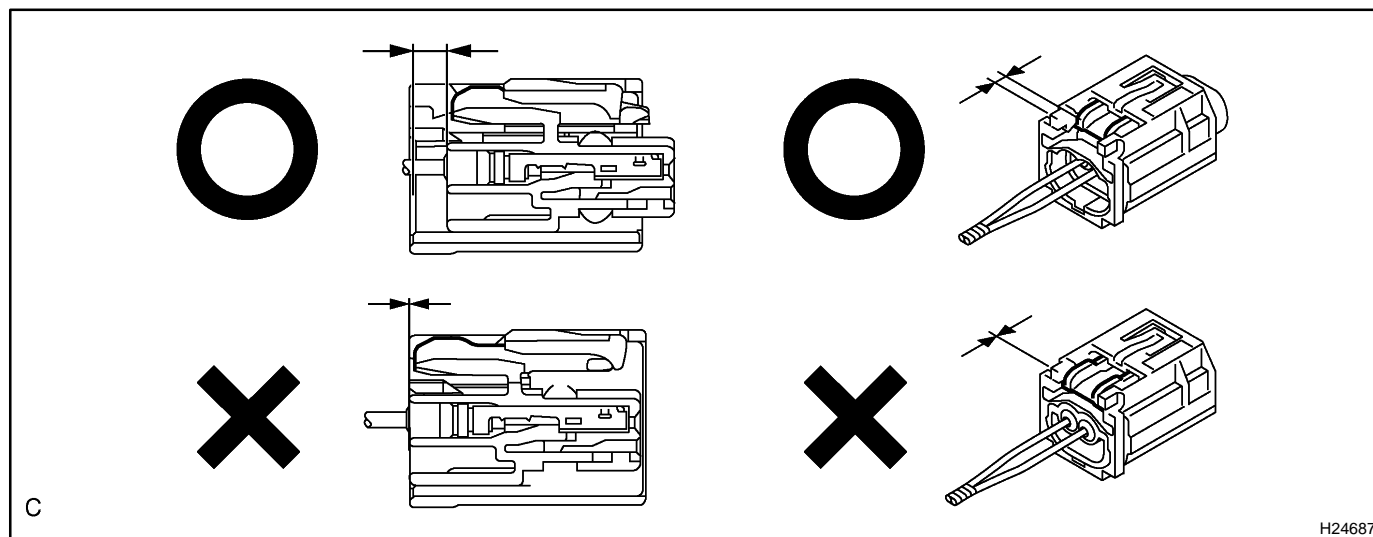

- (b) Be sure to engage the connectors until they are locked. (When locking, make sure that a click sound can be heard.)

HINT:

When connecting them, the housing lock (white part) slides. Be sure not to hold the housing lock (white part) and A part, as it may result in an insecure fit.

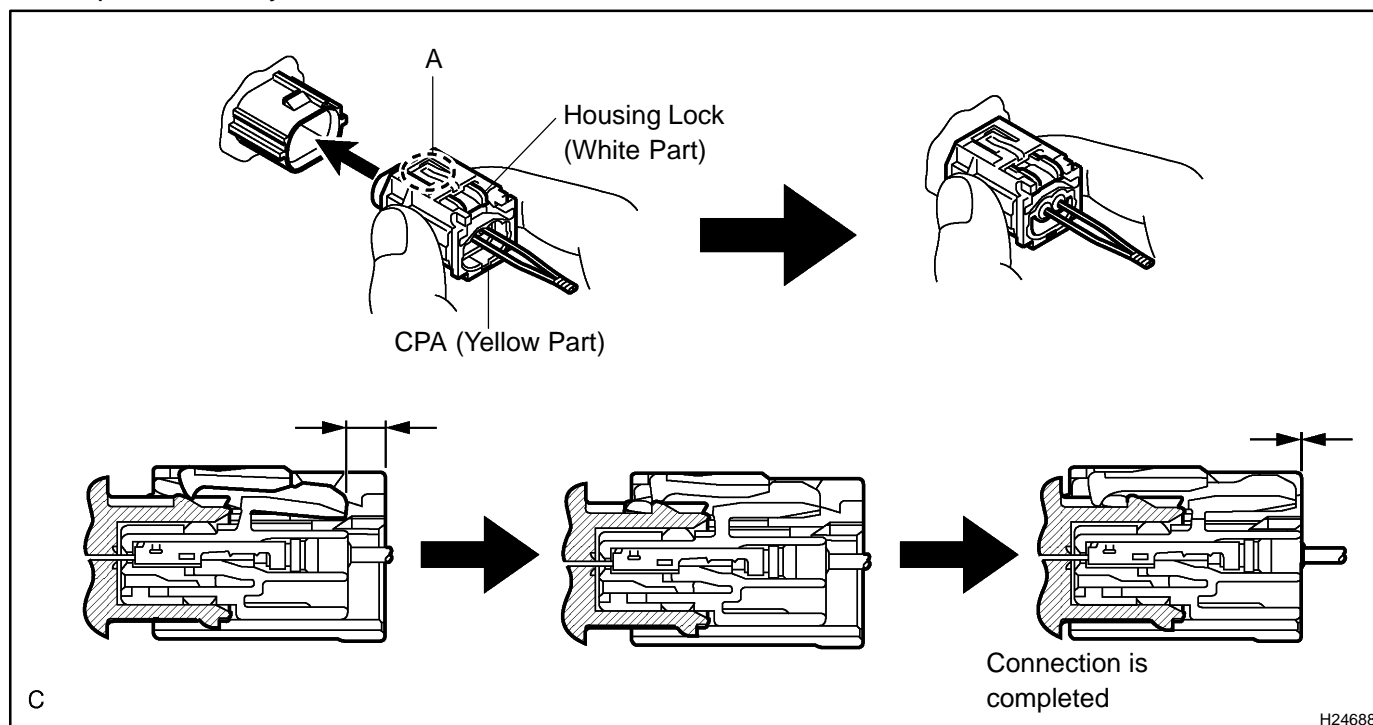

25. DISCONNECTION OF CONNECTOR FOR SIDE AIRBAG ASSEMBLY

- (a) Place a finger on the slider, slide the slider to release the lock, and then disconnect the connector.

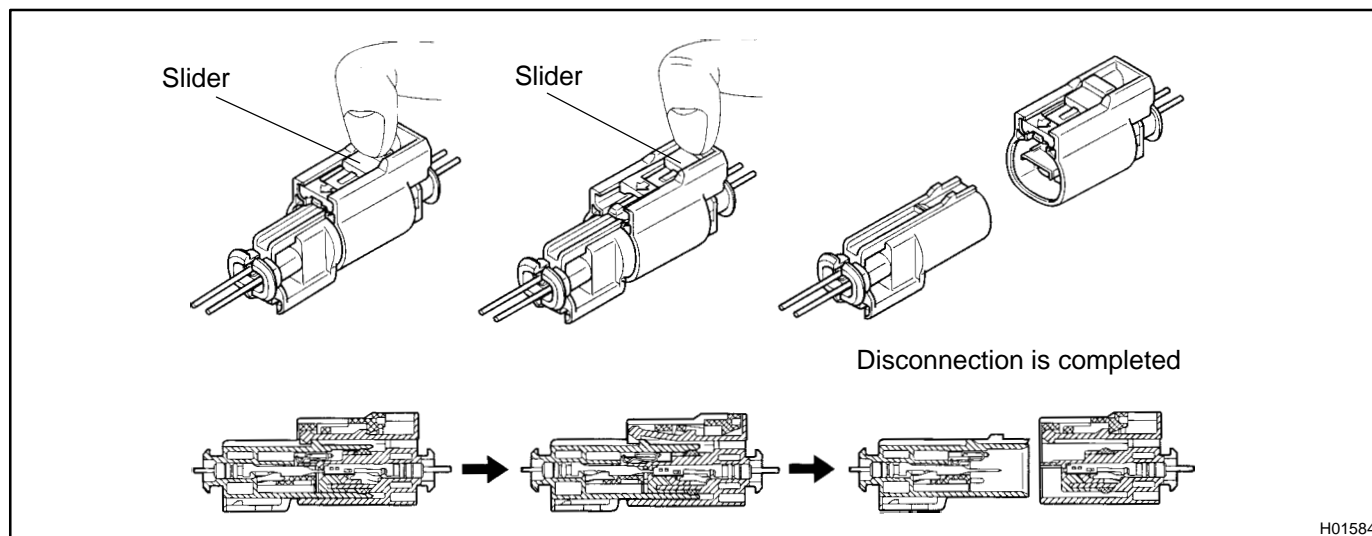
**26. CONNECTION OF CONNECTOR FOR SIDE AIRBAG ASSEMBLY**

- (a) Connect the connector as shown in the illustration. (When locking, make sure that the slider returns to its original position and a click sound can be heard.)

HINT:

When connecting, the slider will slide. Be sure not to touch the slider while connecting, as it may result in an insecure fit.

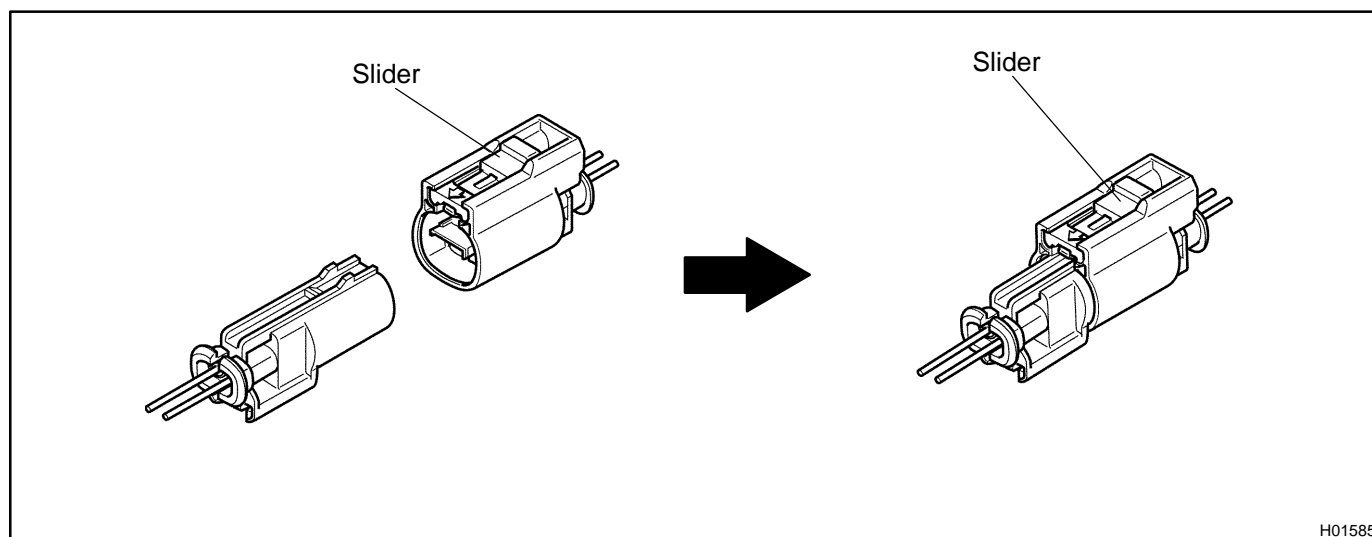

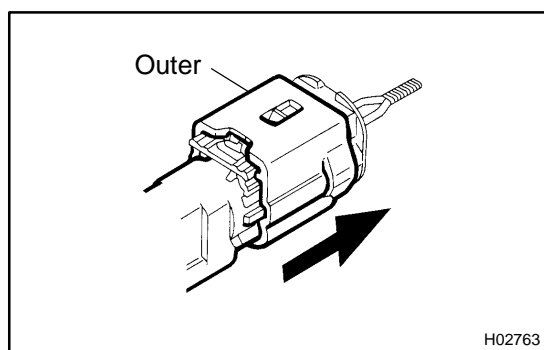

27. DISCONNECTION OF CONNECTORS FOR SIDE AIRBAG SENSOR AND CURTAIN SHIELD AIRBAG SENSOR

- While holding both outer flank sides, slide the outer in the direction shown by the arrow.
- When the connector lock is released, the connectors are disconnected.

HINT:

Be sure to hold both outer flank sides. Holding the top and bottom sides will make disconnection difficult.

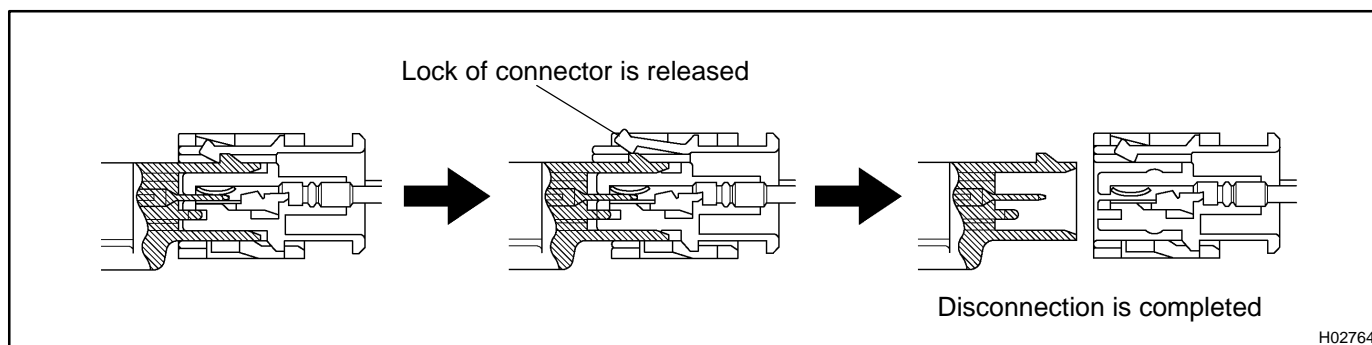

28. CONNECTION OF CONNECTORS FOR SIDE AIRBAG SENSOR AND CURTAIN SHIELD AIRBAG SENSOR

- Connect the connector as shown in the illustration. (When locking, make sure that the outer returns to its original position and a click sound can be heard.)

HINT:

When connecting, the outer will slide. Be sure not to hold the outer while connecting, as it may result in an insecure fit.

